



Central Office:

Yanguas y Miranda, 1 Bajo
Apdo. de Correos nº 359
31080 PAMPLONA
Tel.: 902 153 021
Fax: 948 207 101
e-mail: comercial@triman.es
www.triman.es

Factory:

Pol. Ondarria, s/n.
31800 ALSASUA Navarra



Vertical shaft crusher Triman

TMV



TMV VERTICAL SHAFT CRUSHER

TMV VERTICAL SHAFT CRUSHER

TRIMAN, an expert manufacturer of sandmaking machines, and very well known for its Tmi impact breaker models with over 500 units in service, has developed a new vertical shaft impact breaker. This model is a considerable improvement on crushers currently in the market while meeting growing demands.

1. Improved safety and lower maintenance.

- Machine with hydraulic opening.
- Weight of replacement parts very low.
- Easy to assemble and disassemble.
- High-quality wear-proof materials.
- Very long intervals between services.
- Automatic lubrication with oil pump.

2. Lower operating costs.

Rock-Rock

Specialised for highly abrasive materials, production of sand or improving the coefficient by just modifying the speed.

Rock-Anvil

Specialised in the production of average-abrasive sands and materials, with low infeed rates.

Shoe-anvil

Specialised in moderately abrasive materials and thicker infeeds.

3. Reduction in investment

Modern design, adapted to current efficient manufacturing techniques.
Versatility: the machine can be converted to work rock-rock, rock-anvil, or shoe-anvil.

4. Improvement in the quality of the product obtained.

Optimal cubicity
Versatility in obtaining gravel or sand
Great capacity for reduction
High-quality sands

Rock-Rock



Rock-Anvil

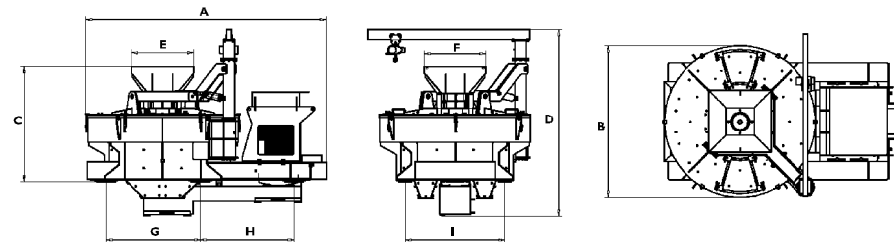
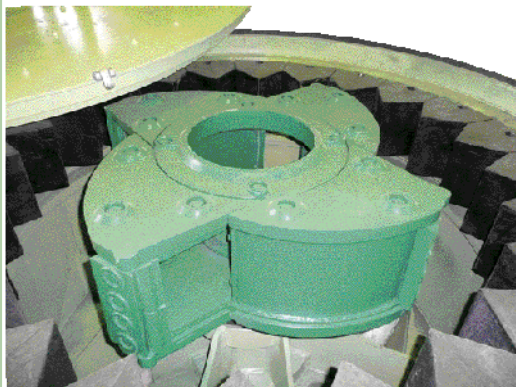

GENERAL DIMENSIONS (mm)

MODEL	A	B	C	D	E	F	G	H	I
TMV-2	3.700	2.144	1.834	2.990	1.000	1.000	1.622	1.325	1.510
TMV-3	3.893	2.444	1.865	2.995	1.000	1.000	1.519	1.519	1.610

MODEL	Rock-Rock Rock-Anvil	Launcher- Anvil	Angular velocity m/sec.	Ø Rotor mm	Production T/h Max.	Power Kw	Weight with Anvil	Weight without Anvil
TMV-2	60	100	70	950	180-440	132-315	9.000	7.500
TMV-3	70	140	80	1.050	270-680	200-500	11.500	9.500

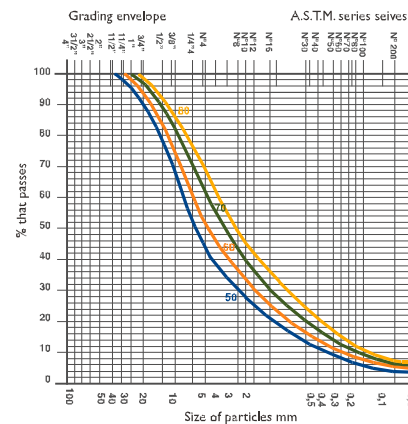

Power curves depending on the speed and flow rate

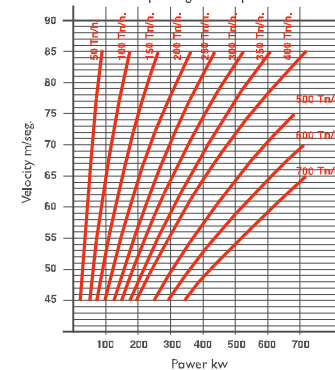

Ratio size infeed/velocity Rock-Rock / Rock-Anvil

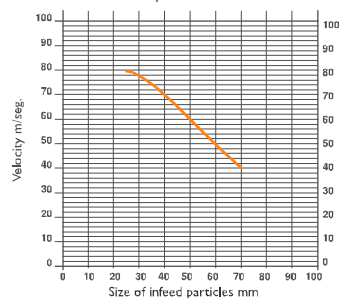

Ratio size infeed/velocity Launcher-Anvil

